

# Setting up Two TVs with One Set Top Box

## Both TVs will be on the Same Channel

### At Your TV #1:

1. Disconnect the Coax Cable running from your TV to the Coax outlet in the wall.
2. Power up your Amino Set Top Box by connecting it to a wall outlet using the included power adapter.
3. Connect TV #1 using HDMI, Component or Composite with the instructions provided.
4. Connect the Set Top Box to the coax port in the wall using a coax cable.

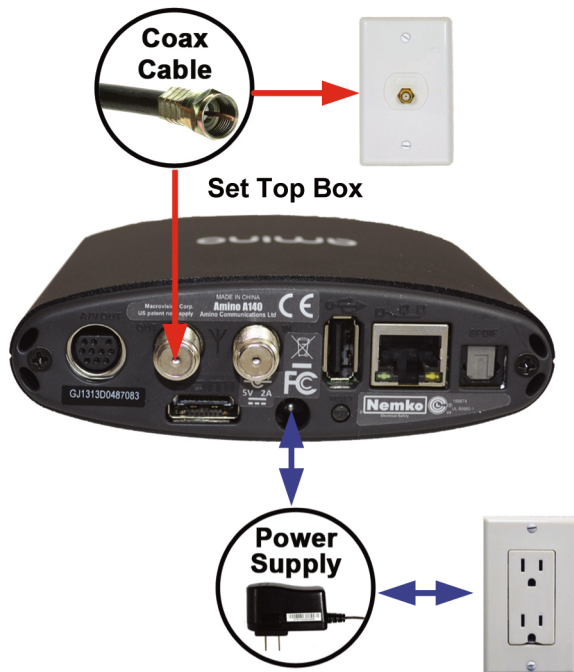

### At Your TV #2:

1. Connect the Coax Cable from your TV to the Coax outlet in the wall.
2. Turn on both TVs. TV #2 must be tuned to channel 3. Verify they are both running the same program.

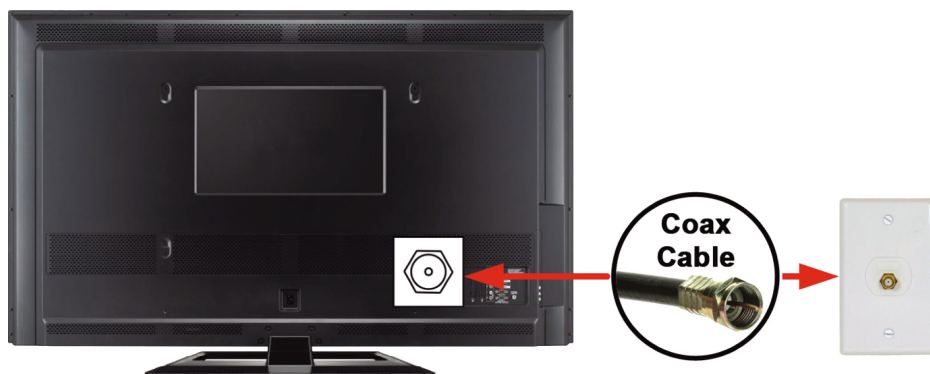

© 2020 Nedelco, Inc.